

RESOLUTION NO. 2023-01

A RESOLUTION OF THE BOARD OF SUPERVISORS OF THE WESBRIDGE COMMUNITY DEVELOPMENT DISTRICT ADOPTING RESTRICTIONS ON PARKING ON DISTRICT OWNED ROADWAYS AND PARKING SPACES; AUTHORIZING THE ENGAGEMENT OF AN AUTHORIZED TOWING OPERATOR; PROVIDING FOR CONFLICTS AND SEVERABILITY; AND PROVIDING AN EFFECTIVE DATE.

WHEREAS, the Wesbridge Community Development District (the "**District**") is a local unit of special-purpose government created and existing pursuant to Chapter 190, Florida Statutes, being situated in Pasco County, Florida;

WHEREAS, the District is the owner of real property as provided for in Section 715.07(2), in particular the District-owned roadways and parking spaces and other areas as identified on **Exhibit "A"**;

WHEREAS, the Board of Supervisors of the District (the "**Board**") is authorized by Sections 190.011(15) and 190.012(2)(d), Florida Statutes, to contract with a towing operator to remove vehicles from District-Owned Property if the notice and procedural requirements of section 715.07, Florida Statutes, are followed;

WHEREAS, unauthorized vehicles or vessels on the District-Owned Property may pose a danger or cause a hazard to the health, safety, and welfare of the District, its residents, its infrastructure, and the general public;

WHEREAS, vehicles or vessels parked on the District-owned roadways cause passing vehicles to cross the centerline and potentially block fire and rescue vehicles;

WHEREAS, the District desires to contract with a towing operator that is included on an approved list of towing operators in Pasco County, Florida, to tow unauthorized vehicles from District-Owned Property; and

WHEREAS, the Board held a public meeting to receive public comment on its proposed parking and towing policy.

NOW, THEREFORE, BE IT RESOLVED BY THE BOARD:

1. **Incorporation of Recitals.** The above recitals are true and correct and by this reference are incorporated as a material part of this resolution.
2. **Adoption of Parking Restrictions and Towing Directives.** The Board hereby adopts the Parking restrictions and Towing directives attached hereto as **Exhibit "B"**.
3. **Authorizing the Engagement of an Approved Towing Operator.**

- (a) The Board hereby authorizes the District to enter into an agreement with a company that is authorized to perform towing or wrecker services in compliance with Florida law, applicable Pasco County regulations, and the Parking restrictions and Towing directives.
 - (b) The District shall coordinate with the towing operator to ensure that the required signage shall be posted on District-Owned Property in the manner required by applicable laws and regulations (including specifically Section 715.07, Florida Statutes).
4. **Conflicts.** This Resolution replaces any prior resolutions, policies, rules, actions or any portion or content included therein in conflict with this resolution.
5. **Severability.** If any section or part of a section of this resolution is declared invalid, unconstitutional, or inconsistent with any law or regulation, the validity, force and effect of any other section or part of a section of this resolution shall not thereby be affected or impaired unless it clearly appears that such part of this resolution is wholly or necessarily dependent upon the section or part of a section so held to be invalid or unconstitutional.
6. **Effective Date.** This Resolution shall become effective upon its passage and shall remain in effect unless rescinded, repealed, replaced, or superseded.

Passed and Adopted on January 19, 2023

Attest:

Wesbridge Community Development District



Assistant Secretary



Name: Raymond Blair
Chair of the Board of Supervisors

Exhibit "A"
Wesbridge CDD
Parking Restrictions and Towing Directives

The Wesbridge Community Development District (the "**District**") has adopted the parking restrictions regarding the parking and towing of vehicles or vessels of any kind (as defined by Section 715.07, Florida Statutes) located on District-Owned Property, described and/or depicted on the attached diagram.

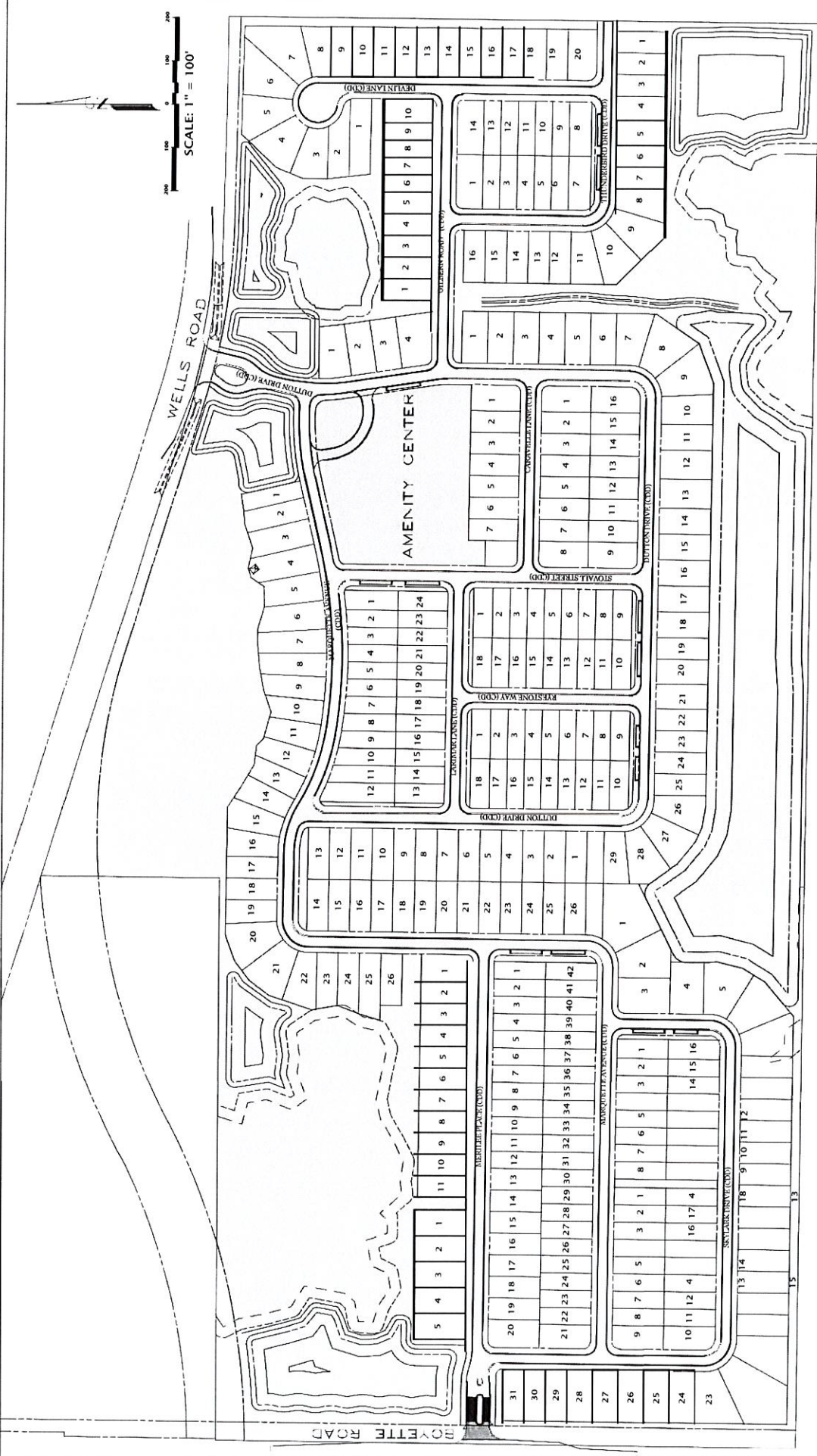

22 21 20 19 18 17 16 15 14 13 12 11 10 9 8 7 6

WESBRID
GE CDD

PREPARED BY:

Clearvie

W

LAND DESIGN
P.L.

Registered Business Number:
R122852
3900, McArthur Road, Suite 550,
Tampa, Florida 33609
Office: 813-243-3919 Fax: 813-
243-3976

HOA PROPERTY

CDD PROPERTY

GUEST PARKING

Exhibit "B"
Parking Restrictions and Towing Directives

The term District-Owned Property shall include all common areas and sidewalks. These restrictions are in addition to, and exclusive of, various state laws, county regulations, or homeowners' association standards governing parking.

1. There shall be no parking of vehicles or vessels at any time on District-Owned Property, except that parking is allowed during permitted hours only in or on a properly posted Parking Area in accordance with these restrictions.

2. No automobiles, motorcycles, or vehicles or vessels of any kind or nature may be parked overnight on District-Owned Property designated as a Parking Area.

3. Upon discovery of a violation, the towing operator with whom the District enters into a towing authorization agreement shall photograph the evidence of such violation and may then tow the vehicle or vessel from District-Owned Property in accordance with said agreement.

4. The towing operator may patrol the District-Owned Property for violations of this Policy (roam towing) but must receive authorization to tow from the District Manager or District Board members.

5. Only the District Manager and District Board members may initiate the towing of a vehicle or vessel.

6. Except in the case of an emergency (which shall be determined in the sole discretion of the District Manager or the District Board members), a notice flyer shall be placed on the windshield of the vehicle or vessel providing notification that the vehicle or vessel will be towed at any subsequent time.

This policy was adopted by Resolution No. 2022-____ on _____, 2022